

# *S6000 Medical Air Compressor*

## *50 psi High Volume Nebulization Compressor*



Compact and quiet, the Schuco<sup>®</sup> S6000 Medical Air Compressor provides up to 14 lpm continuous air flow at 50 psi. The unit operates quietly and effectively using standard 115 VAC current, and is easy to clean with minimal maintenance. The S6000 is compact, with a footprint 20% smaller than other compressors. It is lightweight at about 17 lbs., and the integrated handle and instrument panel cover make it very portable. It comes complete with a removable L-bracket for use with humidifier bottles, and an instrumentation panel cover for protection during transport or when the compressor is not in use.

The S6000 is rated for continuous or intermittent use at an output rating of 14 lpm @ 50 psig. Permanently lubricated bearings are designed for extended operation in the home environment. A vibration-free 0-100 psi gauge delivers accurate readings, while a dial-and-lock pressure regulator ensures that the desired pressure and air flow setting is maintained.

Cool-running, quiet, and lightweight, the S6000 is ideal for use with high-pressure or low-pressure aerosol administration devices, including large-volume and small-volume nebulizers and bubble humidifiers.



# S6000 Medical Air Compressor

## 50 psi High Volume Nebulization Compressor

Cover attaches easily to compressor when not in use

Compact unit has a footprint 20% smaller than other compressors

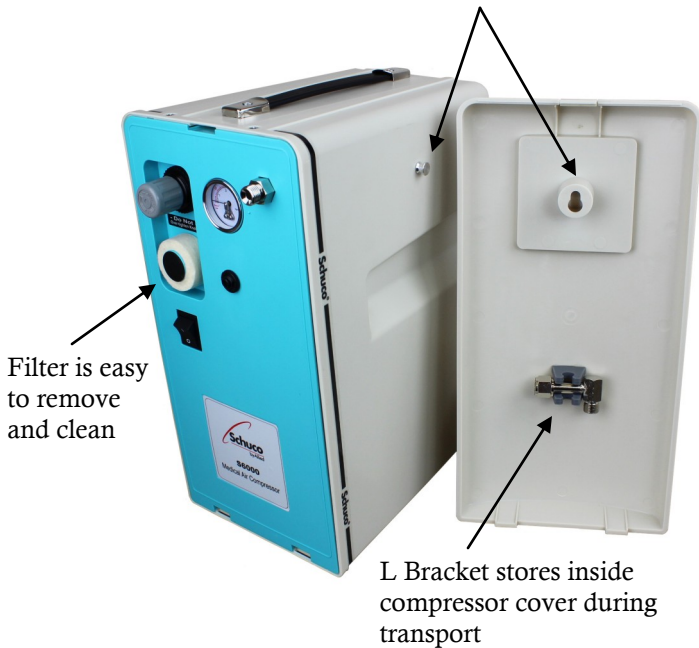

### SPECIFICATIONS

Dimensions: 12.2" D x 7.7" W x 15.3" H (310 mm x 196 mm x 390 mm)

Weight: 17.2 lbs. (7.8 kg)

Output: 14 lpm @ 50 psig/27 lpm @ 20 psig

Outlet: oxygen male DISS (included L-bracket stores inside panel cover)

Sound level: <60 dBA

Pressure Gauge: 0-100 psi

Pressure Regulator: 0-50 psi

Operating Temperature Range: 50° F ~ 104° F (10° ~ 40° C)

Power Cord: 7.5' (2.28 m) with hospital-grade plug

Electrical: 115 VAC, 60 Hz, 5 amps

Warranty: one year

Electrical Safety: IEC 60601-1 compliant; UL listed

### ORDERING INFORMATION

**S6000** Medical Air Compressor, 115 volt, 60 Hz, L bracket, filter, cover

**S6000-905** L Bracket

**S6000-903** Filter, 3/pkg.



Allied Healthcare Products, Inc. ▪ 1720 Sublette Avenue ▪ St. Louis, MO 63110 USA  
314/771-2400 ▪ 800/444-3954 ▪ FAX: 314/771-0650 ▪ www.alliedhpi.com

U.S.  
Toll Free: 800/444-3940  
FAX: 800/477-7701

Canada & Mexico  
Toll Free: 800/446-0552  
FAX: 800/246-6201

International  
Telephone: 314/268-1683  
FAX: 314/771-5183

ISO 13485: 2003

©Allied Healthcare Products, Inc.®

All specifications are nominal and subject to change without notice.

Form 23-00-0009  
Rev. March 2013